

Heart Bear Eyelet Lace Dress & Flower - DRAFT

Materials: approx. 45g double knitting yarn
Needles: two 4mm short circular needles or a set of five 4mm double point needles (dpns)
Notions: sharp darning needle, row counter (optional), 30cm piece of hat elastic (for flower)
Gauge: xx stitches, xx rows = 10cm X 10cm
Sizing: Fits teddy with a waist of around 28cms
Note:

- Dress is knit from hem to neck, back and front are identical
- It's knit in the round, with half of the sts on each circular needle (or set of dpns)
- hems are knit in eyelet lace edge stitch
- eyelet lace stitch is knit in multiples of 10 sts, reducing over three rows to multiples of 5 sts
- eyelet row pattern – k3, slip last st back onto LH needle, slip next 7 sts over this st and off LH needle, yo, knit slipped st again
- use short yarn tails (8 cm) unless directed otherwise

Abbreviations and techniques: see attached sheets



Dress skirt eyelet lace edging:

Cast on 200 sts using the cable cast-on method in knit, place half the sts on one circular needle and half on the other. Join in the round being careful not to twist the sts.

Row 1 (RS) – knit (200 sts)

Row 2 (RS) – [k3, slip last st back onto LH needle, slip the next 7 sts over this st and off the LH needle, yo, knit slipped st again] rep 19 times (80 sts)

Turn and work Row 3 on WS

Row 3 (WS) – [pfb, p3] rep 19 times (100 sts)

Turn again and continue on RS

(knit next 27 rows in stst)

Rows 4 to 30 – knit (100 sts)

Dress waist shaping

Restart numbering rows from 1

Row 1 – k1, [k2tog] 22 times, [k2tog, k1] 2 times, [k2tog] 22 times, k2tog, k1, k2tog (52 sts)

(knit next 8 rows in stst)

Rows 2 to 9 – knit (52 sts)

Divide for Front and Back

Row 10 – k26, cast-off 8 sts, k18

Row 11 – cast-off 8 sts, k18, turn

Left Sleeve

(eyelet lace knit back and forth)

Sleeve Row 1 (WS) – cast-on 40 sts using the cable cast-on method in purl, p40, p2tog, turn (57 sts) (57 sts = 17sts from Back and 40sts from the Left Sleeve)

(wrap one stitch to prevent a hole)

Sleeve Row 2 (RS) – yfd, slip last st from RH needle to LH needle, yarn back, slip stitch back to RH needle, k1

(begin eyelet row pattern)

[k3, slip last st back onto LH needle, slip the next 7 sts over this st and off the LH needle, yo, knit slipped st again] rep 3 times, turn (16 sleeve sts)

Sleeve Row 3 (WS) - [pfb, p3] rep 3 times, turn (20 sleeve sts)

(wrap one stitch to prevent a hole)

*Sleeve Row 4 (RS) – yfd, slip last st from RH needle to LH needle, yarn back, slip stitch back to RH needle, k19, k2tog**

* the second stitch knitted together is the first stitch from the Front (or Back when knitting the Right Sleeve)

You should have 37 sts on your RH needle – 17 from Back and 20 from the Left Sleeve

Row 11 – continued – k17 sts, turn

Right Sleeve

(eyelet lace knit back and forth)
Rep Sleeve Rows 1 to 4

You should have total 72 sts, 36 sts for Back and Left Sleeve and 36 sts for Front and Right Sleeve.

Dress yoke

Rows 12 to 17 – knit (72 sts)

Dress yoke shaping 1 (Y¹)

(72 sts evenly reduced to 54 sts)

Row 18 – k1, [k2tog, k2] 17 times, k2tog, k1 (54 sts)

Rows 19 to 21 – knit (54 sts)

Dress yoke shaping 2 (Y²)

(54 sts evenly reduced to 48 sts)

Row 22 – k4, [k2tog, k7] 5 times, k2tog, k3 (48 sts)

Rows 23 to 25 – knit (48 sts)

Dress yoke shaping 3 (Y³)

(48 sts evenly reduced to 42 sts)

Row 26 – k3, [k2tog, k6] 5 times, k2tog, k3 (42 sts)

Row 27 – knit (42 sts)

Begin Picot Stitch Cast-off

Row 28 – purl

Row 29 – [cast-on 2 sts with the cable cast-on method in knit, cast off 5 sts] 14 times, picking up a st to knit to the last, cut yarn leaving a short tail.

Dress Finishing

Weave in two ends. Press dress lightly with a steam iron and pressing cloth. This is to smooth out the eyelet lace edges, don't press the neck edge.

Flower

Cast on 42 sts using the cable cast-on method in knit, leaving a 10 cm tail.

Row 1 – [k1, cast off next 5 sts] 5 times (12 sts)

Flower Finishing

Cut yarn leaving a 15 cm tail. Thread tail onto darning needle, thread needle through rem 12 sts, draw up tightly to form flower.

Ties two ends together, being careful not to twist petals. Press each of the six petals lightly.

Tie elastic band into a loop that fits the bear's head, trim ends. Use yarn tails to secure flower to elastic band. Weave in ends.

Diagram illustrating a grid-based layout with various components and labels.

Top Section: A long horizontal bar at the top. Below it, a series of smaller grid blocks are arranged in two rows. The first row contains 7 blocks, and the second row contains 10 blocks. Each block is a grid with some cells shaded or containing symbols.

Middle Section: Two smaller grid blocks, one on the left and one on the right, each with a small grid inside it. Below these are two larger grid blocks, one on the left and one on the right, with a small grid inside each. Labels like "110", "111", and "112" are placed near these grids.

Bottom Section: A large grid structure. The top part of this section is a long horizontal bar with a grid below it. The bottom part is a large grid with a red crosshair. At the very bottom, there is a long horizontal bar with a grid below it, containing many small numbers and symbols.

Labels and Markers: Various labels are scattered throughout the diagram, including "110", "111", "112", "113", "114", "115", "116", "117", "118", "119", "120", "121", "122", "123", "124", "125", "126", "127", "128", "129", "130", "131", "132", "133", "134", "135", "136", "137", "138", "139", "140", "141", "142", "143", "144", "145", "146", "147", "148", "149", "150", "151", "152", "153", "154", "155", "156", "157", "158", "159", "160", "161", "162", "163", "164", "165", "166", "167", "168", "169", "170", "171", "172", "173", "174", "175", "176", "177", "178", "179", "180", "181", "182", "183", "184", "185", "186", "187", "188", "189", "190", "191", "192", "193", "194", "195", "196", "197", "198", "199", "200".

Knitting Abbreviations

★	pattern changes from normal—watch out
[]	work instructions in square brackets the number of times stated
alt	alternate/alternating
approx	approximately
beg	begin/beginning
bet	between
CC	contrast colour
cm	centimetre(s)
cn	cable needle
cont	continue
dec	decrease/decreases/decreasing
dpns	double pointed needles
edge st	knit the first and the last stitch on all rows including purl rows
foll	follow/follows/following
g	gram
inc	increase/increases/increasing
k	knit
k2tog	knit two stitches together
kfb	knit in front and back of stitch to make two stitches from one
kw	knitwise
LH	left hand
m1	make a stitch by picking up the stitch between stitches, twist it and knit into the back of it
MC	main colour
p	purl
p2tog	purl two stitches together
pfb	purl in front and back of stitch to make two stitches from one

pm	place marker
prev	previous
psso	pass slipped stitch(es) over
pw	purlwise
rem	remain/remaining
rep	repeat
RH	right hand
RS	right side(s)
sk	skip
skpo	slip one stitch knitwise, knit one, pass slipped stitch over—one stitch decreased
ssk	slip two stitches one at a time knitwise, insert point of left-hand needle into the fronts of these two stitches and knit them together (this is interchangeable with skpo above)
s2kpo	slip two stitches as if to knit two together, knit one, pass slipped stitches over—two stitches decreased
sk2po	slip one knitwise, knit two together, pass slipped stitch over—two stitches decreased
sl	slip
sl1k	slip one stitch knitwise
sl1p	slip one stitch purlwise
stst	stockingnette stitch—knit right side rows, purl wrong side rows
st(s)	stitch(es)
tbl	through the back of the loop(s)
tog	together
WS	wrong side(s)
yfd	yarn forward
yo	yarn forward and over needle to make a stitch



Knitting Techniques

cast-on methods

All knitting begins with a cast-on, which creates loops on the needle. See the following link for numerous types of cast-on methods.

<http://www.knittinghelp.com/videos/cast-on>

knitwise cable cast-on

A firm, non elastic cast-on. Stay loose, or it can be quite difficult to get the yarn through.

<http://newstitchaday.com/cable-cast-on-knitting/> or

<http://www.knittinghelp.com/videos/cast-on>

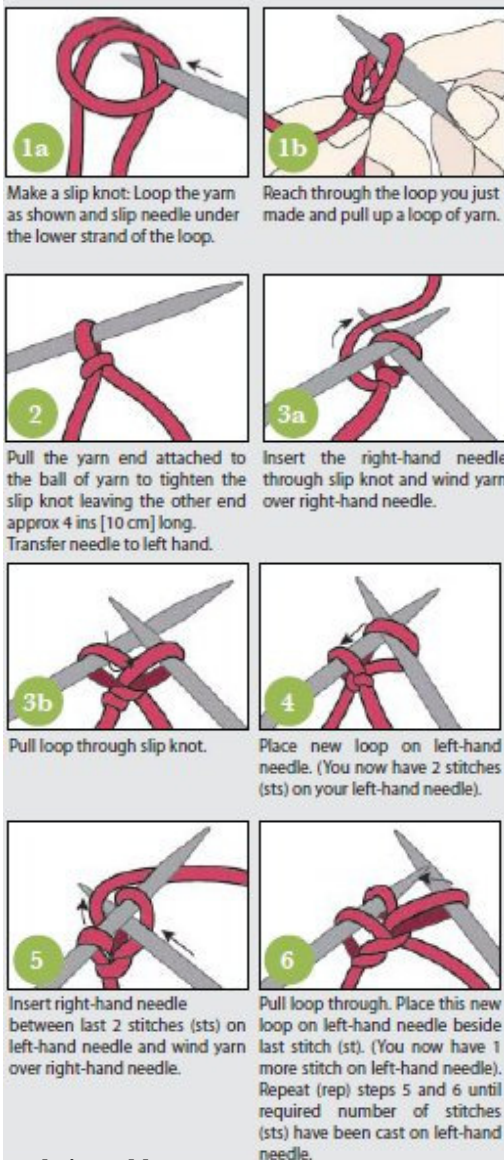

purlwise cable cast-on

Same as the knitwise cable cast-on, but worked on the wrong side of the work, using purl stitch.

<https://www.youtube.com/watch?v=2ZOB888eDtQ>

alternating cable cast-on

This has a very discreet edge against k1 p1 ribbing. Also a very elastic, easy cast-on method.

<http://newstitchaday.com/alternating-cable-cast-on-knitting/>

<http://www.knittinghelp.com/videos/cast-on>

wrap cast-on

(aka backward loop cast-on or single cast-on)

Easiest method to learn, but tricky to knit from evenly.

<http://www.knittinghelp.com/videos/cast-on>

mattress stitch

Makes an invisible side seam.

<http://www.knittinghelp.com/videos/knitting-tips>

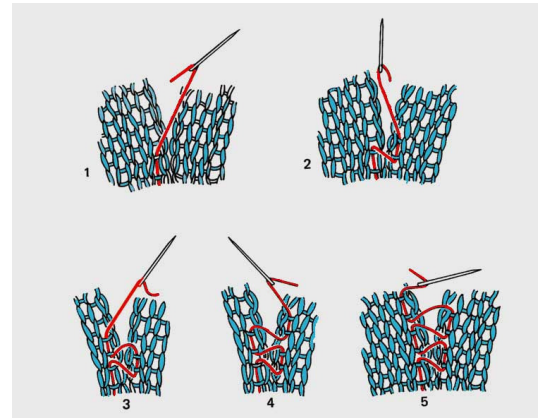

three-needle bind-off

Firm method, not invisible, for binding off two pieces together, creating a seam between them. Great for seaming shoulders.

With right sides facing each other, insert the tip of a third needle into the first stitch of one needle, then into the first stitch of the other needle. Knit two stitches together. *knit the next stitch from each needle together. Pass the previous stitch over this stitch. Rep from *. To view a video see

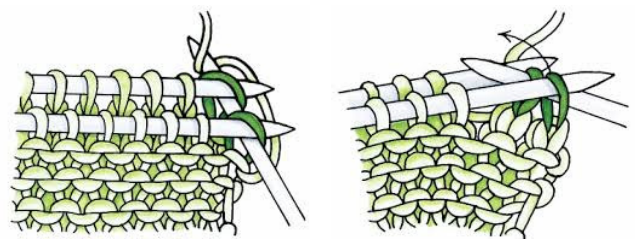

<http://www.knittinghelp.com/videos/knitting-tips>